

5.39 Ac Andermann Commercial
12445 S 248th Ave
Plainfield IL 60585



5.39 AC ANDERMANN COMMERCIAL

12445 S 248th Ave
Plainfield IL 60585

For more information contact:

Mark Goodwin
1-815-741-2226
mgoodwin@bigfarms.com

Goodwin & Associates Real Estate, LLC
is an AGENT of the SELLERS.



County:	Will
Township:	Wheatland
Gross Land Area:	5.39 Acres
Property Type:	Land with one large old farmhouse and farm buildings
Possible Uses:	Medical office or assisted living.
Total Investment:	\$1,760,913
Unit Price:	\$7.50 per square foot
Buildings:	There is one homes, barns, and grain storage at this site
Utilities:	Are near the site
Zoning:	Unincorporated Will County, but future annexation to Plainfield is readily available.



- Excellent location near Edwards Hospital Plainfield campus
- Just South of Plainfield North High School
- Utilities near site
- Commercial zoning available
- Great road frontage on 248th
- Commercial corner at 248th and Prairie Grove Rd.

The parcel is in the Plainfield Medical District. Many farm buildings and one two story farmhous could generate additional revenue until development occurs. Assisted living and medical office are idea uses for this parcel. Easy access to shopping at Rt 59. The ranch home has been sold to a residential developer to create an new intersection with Prairie Grove road and 248th. This also creates a corner commercial property at that intersection.



Mark Goodwin
Phone: 815-741-2226
mgoodwin@bigfarms.com

LISTING DETAILS

GENERAL INFORMATION

Listing Name: 5 Acre Andermann Commercial Corner

Tax ID Number/APN: Two Tax ID #'s 07-01-28-300-018, 07-01-28-300-022

Possible Uses: The parcel is in the Plainfield Medical District. Many farm buildings with two story farmhouse could generate additional revenue until development occurs. Assisted living and medical office are idea uses for this parcel.

Zoning: Unincorporated Will County, but future annexation to Plainfield is readily available. Commercial zoning available.

AREA & LOCATION

School District: Plainfield Community Unit School District 202

Location Description: Great North Plainfield location between Plainfield North High School and Edward Hospital Plainfield clinic. The property is on 248th Avenue just north of 127th, one mile west of Rt. 59 and half a mile east of Rt. 30.

Site Description: Old farmstead site. Approximately 3 acres of tillable open land.

Side of Street: East side of 248th Avenue.

Highway Access: Close to both Rt. 30 and Rt. 59

Road Type: Full curb paved street with turn lanes.

Property Visibility: Future access point for the 65 acres behind and around Edwards Medical facility. With the sale of the two acre parcel and ranch home a commercial corner has been developed at this location. 248th and Prairie Grove Dr.

Largest Nearby Street: US Route 30 or Rt. 59

LAND RELATED

Lot Frontage (Feet): There is exposure to 248th street with approximately 342 feet of frontage.

Tillable Acres: Approximately 3 acres of tillable open land.

Lot Depth: The property is approximately 910 feet deep.

Buildings: There is one two story farmhouse, barns, and grain storage on this parcel.

Zoning Description: Unincorporated Will County, but future annexation to Plainfield is readily available. Commercial zoning available.

Flood Plain or Wetlands: No

Topography: Level land

Available Utilities: Are near the site

FINANCIALS

Finance Data Year: 2013

Real Estate Taxes: 07-01-28-300-018 2.04 acres RE Tax \$6,401
07-01-28-300-022 3.35 acres RE Tax \$1,657
Includes farmhouse, barns, and grain storage. Total tax bill of \$8,406

Investment Amount: \$1,760,913 or \$7.50 per square foot for 5.39 Acres.

LOCATION

Address: 12445 S 248th Ave
Plainfield, IL 60585
Latitude 41.655549
Longitude -88.22305

County: Will

MSA: Chicago-Naperville-Elgin

LOCATION MAP

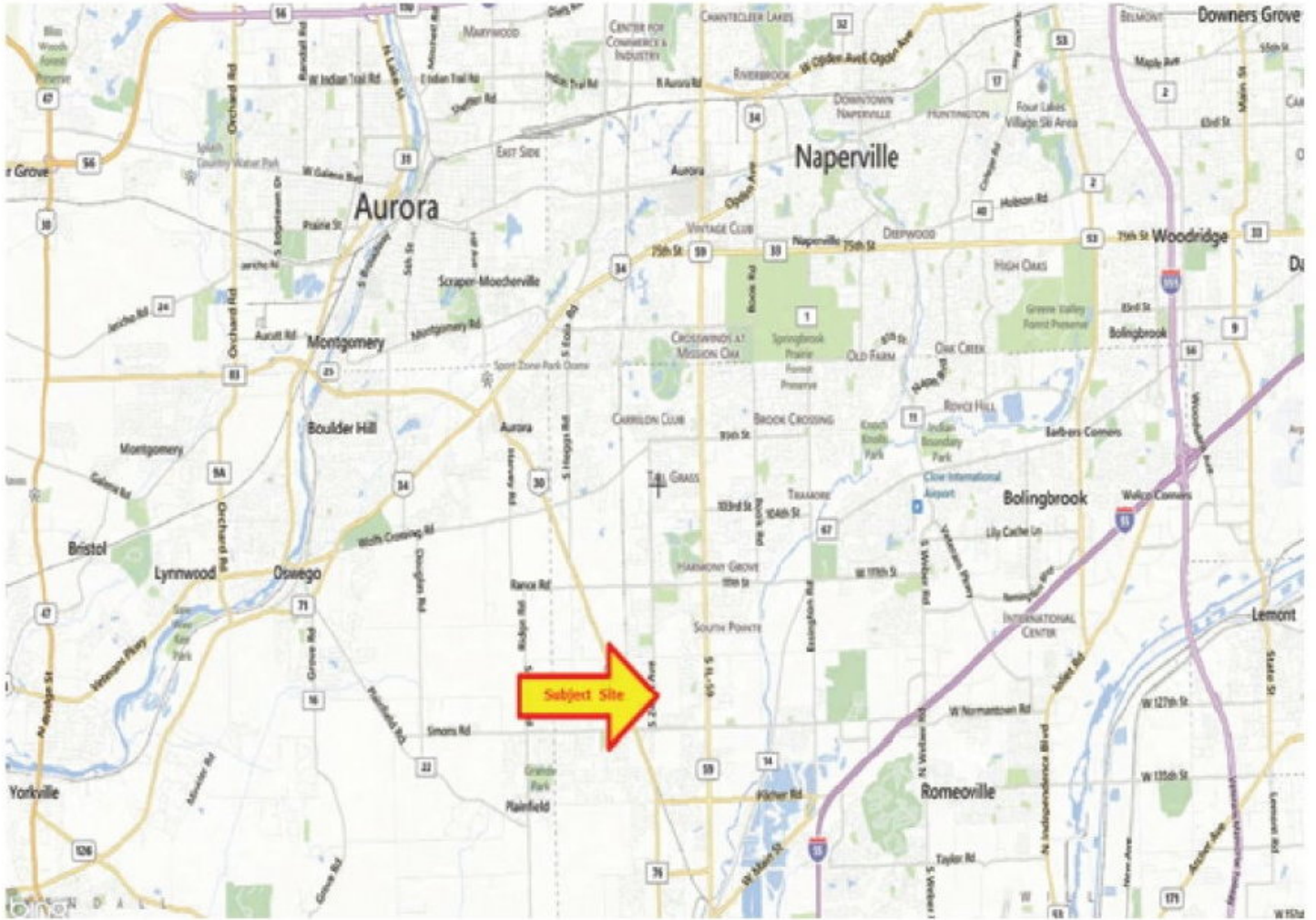

AERIAL MAP 1



AERIAL MAP 2



AERIAL MAP OF PLAINFIELD COMMERCIAL SITE ON 248TH AVE.



PLAT PAGE

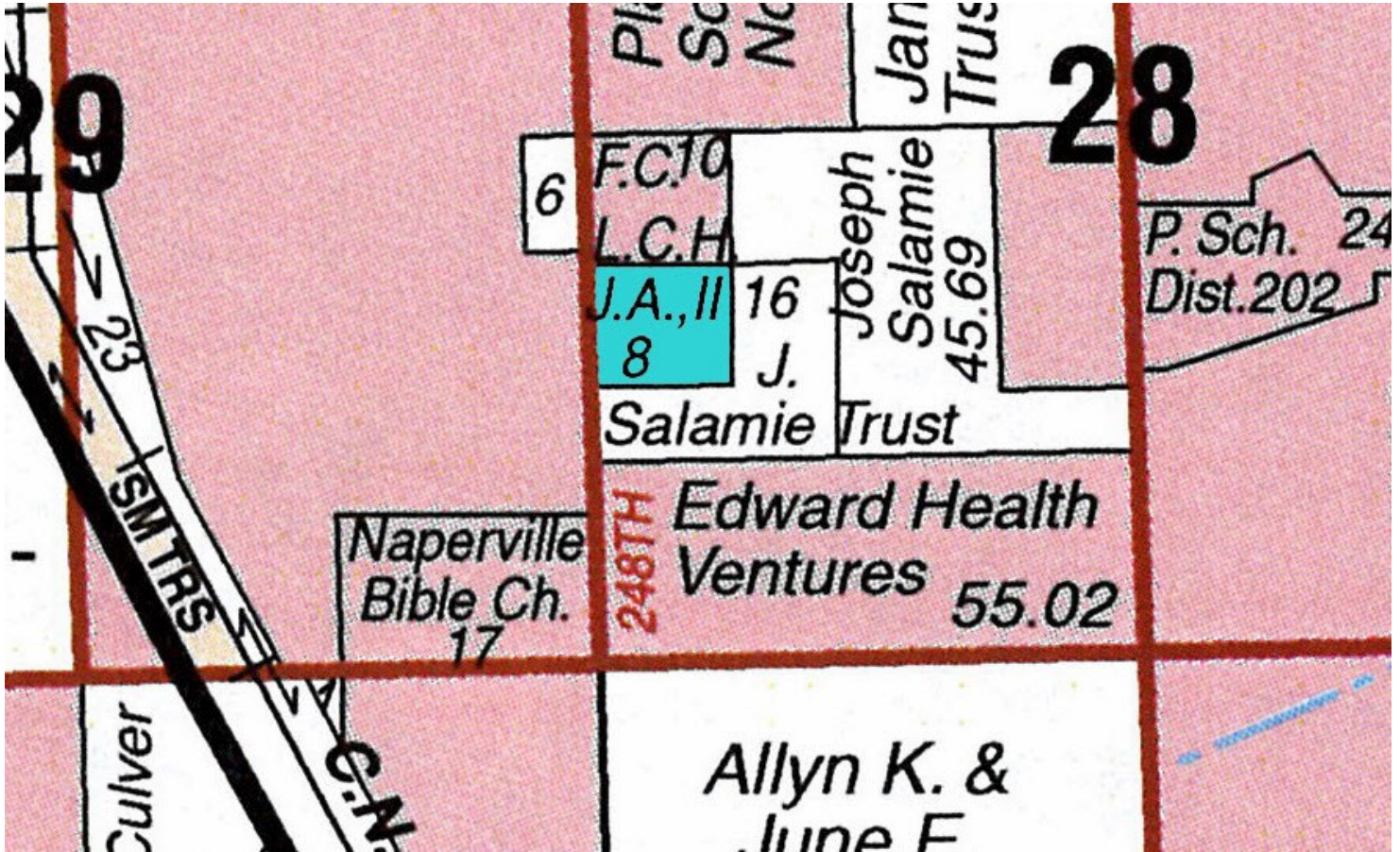

Plat Map reprinted with permission of Rockford Map Publishers, Inc.

MEDICAL COMPREHENSIVE PLAN DISTRICT MAP



MARK GOODWIN PROFESSIONAL BIOGRAPHY

Goodwin & Associates Real Estate, LLC is an experienced Illinois land brokerage firm located in Shorewood, Illinois. We specialize in vacant land sales including farmland and commercial/residential development land. Managing Illinois Land Broker and owner, Mark Goodwin, has extensive background in both agriculture and Real Estate, which provides him the knowledge to effectively negotiate and close transactions.

Since 1996, Mark Goodwin has successfully provided brokerage services to landowners throughout the Midwest earning him the title of Accredited Land Consultant, (ALC) designated by the Realtors Land Institute. Throughout his life experiences Mark has acquired a unique background of understanding both the agricultural side of land sales as well as the development side and has made numerous valuable contacts with land owners, brokers and developers. Mark was awarded Illinois Land Broker of the Year in 2011 by the Illinois RLI Chapter.



AGENCY DISCLOSURE

Goodwin & Associates Real Estate, LLC has previously entered into an agreement with a client to provide certain real estate Illinois brokerage services through a Broker Associate who acts as that client's designated agent. As a result, **Broker Associate will not be acting as your agent but as agent of the seller.**

DISCLAIMER

These materials were prepared by Goodwin & Associates Real Estate, LLC, and contain selected information pertaining to the Property, and do not purport to be all-inclusive or to contain all of the information which prospective investors or users may desire. Additional information and an opportunity to inspect the Property will be made available upon request. Neither the Owner nor Goodwin & Associates Real Estate, LLC, nor any of their respective directors, officers, employees, shareholders or affiliates have made any representation or warranty, express or implied, as to the accuracy or completeness of this Presentation of any of its contents, and no legal commitment or obligation shall arise by reason of the Presentation or its contents. While we obtained the information above from sources we believe to be reliable, we have not verified the occupancy and make no guaranty, warranty or representation about it. It is submitted subject to the possibility of errors, corrections, change of price, or withdrawal without notice. If we have included projections, opinions, assumptions, or estimates they are for the purpose of example only, and may not represent current or future performance of the property. You, your tax, and legal advisers should conduct your own investigations of the property and the transaction.